

CONNECT CAST Orthopedic Casting Tape

This product is made of knitted fiberglass fabric or polyester fabric, and water-activated polyurethane resin. It uses environmental friendly materials, and mainly used for the external fixation of fracture and common orthopedics.

This product has many advantages comparing with plaster bandage. It is the upgraded and replaced product of the traditional plaster bandage.

Fiberglass Casting Tape has higher strength and it is easier to be cut than Polyester Casting Tape.

Polyester Casting Tape can be burnt throughly, so it is more environmental friendly.

How to Use

1. Wear the gloves and choose the proper specifications.
2. Use the cast padding or stockinet on the fixed part.
3. Open a bag and take out the cast, dip in room temperature water for 4-5 seconds and press 2-3 times, take it out and squeeze out the excess water.
4. Wrap the cast spirally according to the need, keep the proper tension. wrap 2-4 layers at non-weight-bearing position and 4-6 layers at weight bearing position.
5. Shape the wrapped cast according to the need. The solidifying time is 3-5 minutes, 20 minutes later the cast reaches the enough strength.
6. Use the electric cast saw to cut and remove it.

Model	Specification (WxL)	Packing
KCF02/KCP02	5.0 cm x 360 cm	10 bags x 12 boxes/cartoon
KCF03/KCP03	7.5 cm x 360 cm	10 bags x 12 boxes/cartoon
KCF04/KCP04	10.0 cm x 360 cm	10 bags x 9 boxes/cartoon
KCF05/KCP05	12.5 cm x 360 cm	10 bags x 9 boxes/cartoon
KCF06/KCP06	15.0 cm x 360 cm	10 bags x 9 boxes/cartoon

Notes

The operator should wear gloves to avoid the polyurethane touching and adhering the skin.

Open one bag at one time and use the case immediately. Don't open multi-bags at the same time, so as to avoid weakening the strength.

The cast need to be cut and removed by the electric cast saw.

Pay attention to avoid breakage of the bags during transportation and storage, for touching moisture in the air can cause the cast to solidify.

Colour Index



Marketed In India :

LACQUIRE ASSOCIATES

16/294, CHB, JDH - 342008 INDIA C.O. : 72, Kalinga House, 5th Lane Andheri (W) MUMBAI - 05
Help Line : +91-8875555294, +91-94141-29817, e-mail : lacquire294@gmail.com



Characteristics

- High Strength
- Light Weight
- Quick Solidifying and Good Mouldability
- Easy Operating
- Excellent X-ray Radiolucency.
- Good Air-permeability.
- Water resistant.
- Environmental Friendly Materials.
- Clean and Comfortable.



Soft Cast

- It is kind of semi-rigid and flexible casting tape.
- It is normally used for crack of bone. sprain of wrist or ankle, damage of soft tissue, and the fixation that need a little movement.
- It is mainly made of polyeter fabric.
- It can be removed by scissor easily.



CONNECT SPLINT Orthopedic Splint

This product is made of knitted fiberglass fabric or polyester fabric, water-activated polyurethane resin and two layers non-woven fabric.

It uses environmental friendly materials, and mainly used for the external fixation of fracture and common orthopedics.

Comparing with orthopedic casting tape, orthopedic splint is normally used in the early days of the fracture, when the fixed part has trauma or swelling.

This product has many advantages comparing with plaster splint. It is the upgraded and replaced product of the traditional plaster Splint.



How to Use

1. According to the different part, choose the proper specification without wearing gloves.
2. Open a bag and take out the splint, dip in warm water for 5-6 seconds and press 2-3 times, take it out, squeeze out the excess water or use dry towel for sucking.
3. Use the splint to cover the fixed part, and wrap with common bandage.
4. Shape according to the need.

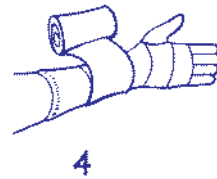
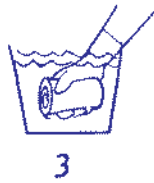
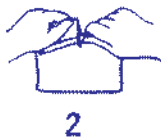

Characteristics

- Good Air-permeability and Anti-bacterial.
- Easy Operating.
- Excellent X-ray Radiolucency.
- Quick Solidifying and Good Mouldability.
- Water-resistant
- Easy Removing
- Environmental Friendly Materials.
- Very clean and comfortable.

Model	Specification (WxL)	Packing
KSF312/KSP312	7.5 cm x 30 cm	20 bags x 6 boxes/cartoon
KSF335/KSP335	7.5 cm x 90 cm	10 bags x 6 boxes/cartoon
KSF415/KSP415	10.0 cm x 40 cm	20 bags x 6 boxes/cartoon
KSF430/KSP430	10.0 cm x 75 cm	10 bags x 6 boxes/cartoon
KSF530/KSP530	12.5 cm x 75 cm	10 bags x 4 boxes/cartoon
KSF545/KSP545	12.5 cm x 115 cm	5 bags x 4 boxes/cartoon
KSF630/KSP630	15.0 cm x 75 cm	10 bags x 4 boxes/cartoon
KSF645/KSP645	15.0 cm x 115 cm	5 bags x 4 boxes/cartoon

Roll Splint

It is one kind of orthopedic splint with 4.5m length.

When using it, the doctor can cut off proper length according to the actual need every time, so as to avoid the waste.

It is more economical than normal orthopedic splint.



Marketed In India :

LACQUIRE ASSOCIATES

16/294, CHB, JDH - 342008 INDIA C.O. : 72, Kalinga House, 5th Lane Andheri (W) MUMBAI - 05
 Help Line : +91-887555294, +91-94141-29817, e-mail : lacquire294@gmail.com