

Butterfly Valve PN16

Butterfly Valve PN16 with Hand Lever Details

Sl. No.	Size		A	B	C	D	E	F	G	H	Shaft End Connection			Flange Mounting (ISO 5211)	Torque in Nm
	In 'mm'	In 'inch'									øJ	K	L		
1	50	2	43	114	70	28	4.5	200	13	35	12	9	25	F07	12
2	65	2½	46	121	75	48	10.5	200	13	35	12	9	25	F07	20
3	80	3	46	128	85	67	17.5	200	13	35	12	9	25	F07	27
4	100	4	52	146	105	88	25	250	13	35	14	11	25	F07	41
5	125	5	56	158	112	114	35.5	250	13	35	14	11	25	F07	62
6	150	6	56	174	134	142	48	300	14	35	18	14	25	F10	93
7	200	8	60	198	160	194	71.5	300	14	35	18	14	25	F10	175

Butterfly Valve PN16 with Cast Hand Lever Details (in 'mm')

Sl. No.	Size		A	B	C	D	E	F	G	H	Shaft End Connection			Flange Mounting (ISO 5211)	Torque in Nm
	In 'mm'	In 'inch'									øJ	K	L		
8	250	10	68	245	200	243.5	92.5	450	14	85	22	17	30	F10	250
9	300	12	78	270	225	292.5	111.5	450	15	85	28	22	40	F12	350

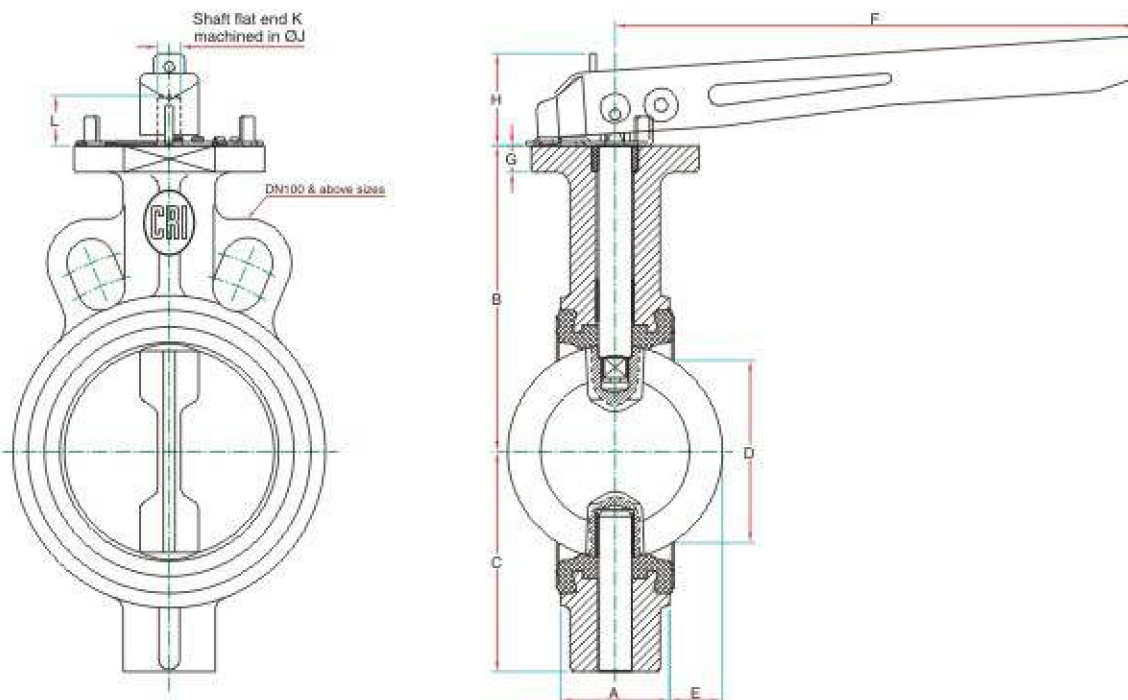

Butterfly Valve PN16 with Worm Gear Details

Sl. No.	Size		A	B	C	D	E	F	G	H	M	N	Shaft End Connection			Flange Mounting (ISO 5211)	Torque in Nm
	In 'mm'	In 'inch'											øJ	K	L		
1	50	2	43	114	70	28	4.5	130	13	130	195	175	12	9	25	F07	12
2	65	2½	46	121	75	48	10.5	130	13	130	195	175	12	9	25	F07	20
3	80	3	46	128	85	67	17.5	130	13	130	195	175	12	9	25	F07	27
4	100	4	52	146	105	88	25	130	13	130	195	175	14	11	25	F07	41
5	125	5	56	158	112	114	35.5	130	13	130	195	175	14	11	25	F07	62
6	150	6	56	174	134	142	48	185	14	165	240	230	18	14	25	F10	93
7	200	8	60	198	160	194	71.5	185	14	165	240	230	18	14	25	F10	175
8	250	10	68	245	200	243.5	92.5	185	14	165	240	230	28	22	40	F10	250
9	300	12	78	270	225	292.5	111.5	255	15	185	285	340	28	22	40	F12	350
10	350	14	78	312.5	262.5	330	130.5	255	15	185	285	340	28	22	40	F12	505
11	400	16	102	360	300	375	142	385	18	345	320	600	36	27	50	F14	790
12	450	18	114	390	325	425	160	385	18	345	320	600	36	27	50	F14	1000
13	500	20	127	410	350	470	180	385	18	330	395	500	48	36	65	F14	1250
14	600	24	154	490	435	570	215	445	23	330	420	500	60	46	70	F16	2250

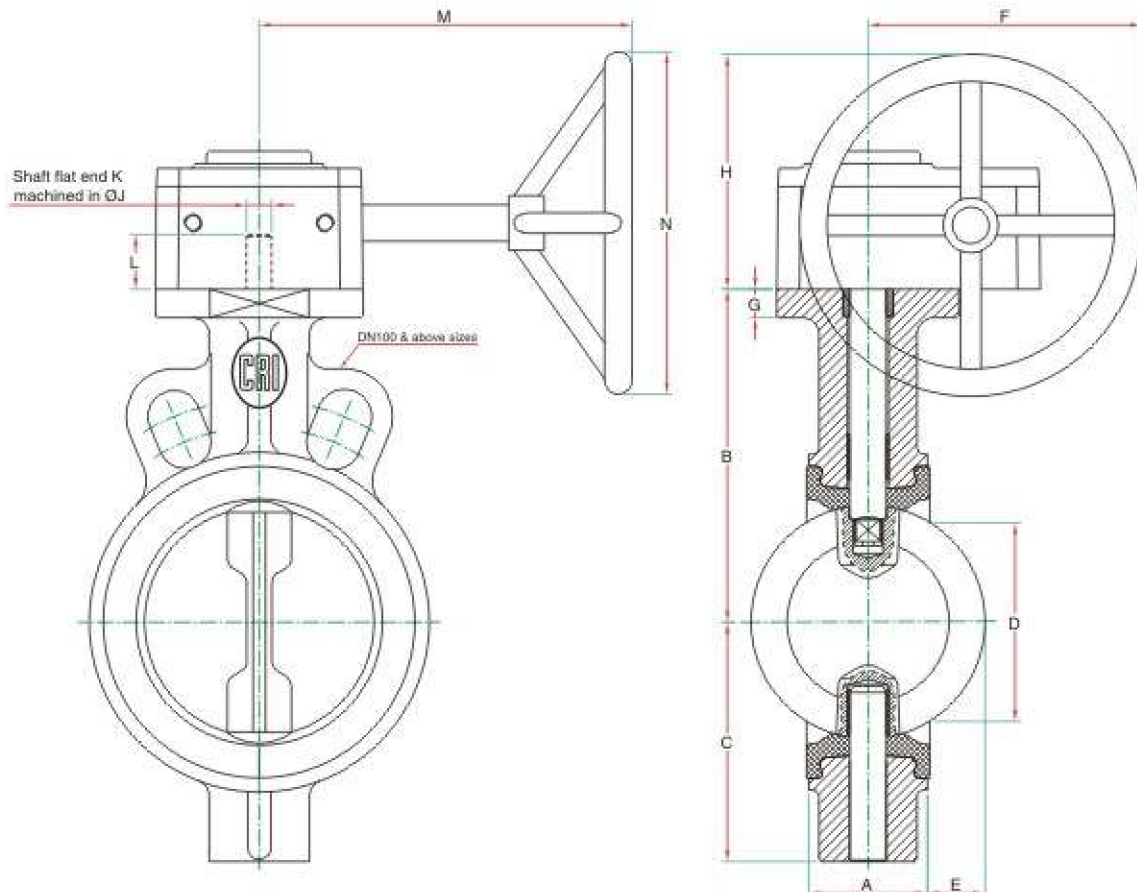

Item	Description	Size (in mm)	Materials specification
101	Body	50 to 600	Type A : IS 210 - FG 260 (or) BS 1452 - Gr. 260 Type B : IS 1865 - SG 450 / 10 (or) ASTM - A 536 (93) (64 - 45 - 12)
102	Disc	50 to 600	Type A : IS 1865 - SG 450 / 10 (or) ASTM - A 536 (93) (64 - 45 - 12) Type B : CF8 (ASTM A 351) Type C : CF8 M (ASTM A 351)
103	Seal	50 to 600	Type A : EPDM Type B : NITRILE
104	Operating Shaft	50 to 600	AISI 310 (or) AISI 410
105	Shaft	50 to 600	AISI 310 (or) AISI 410
106	Bush	50 to 600	PTFE
107	Plain Bearing	100 to 600	PTFE filled on steel casting
108	Plain Bearing	100 to 600	PTFE filled on steel casing

