

## SLIPON FLANGE



### AVAILABLE M.O.C. :

PP ( POLYPROPYLENE )  
HDPE ( HIGH DENSITY POLYETHYLENE )  
ISOTACTIC PP  
PVDF ( POLYVINYLIDENE FLUORIDE )

### \* FLANGE DRILLED

ANSI B 16.5 (150 CLASS)  
BS 10 TABLE D  
BS 10 TABLE E  
BS 10 TABLE F  
DIN. STD

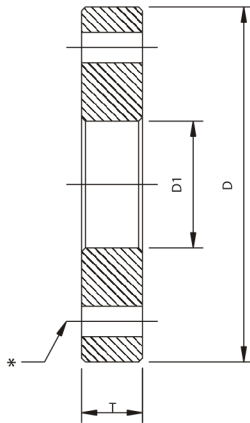

### ALL DIMENSIONS ARE IN MM (±2 MM)

SIZE		Ø D	Ø D1	T
IN.	MM.			
½ "	20	95.0	25.5	16.0
¾ "	25	101.0	32.0	17.5
1 "	32	122.5	37.0	18.5
1 ½ "	40	134.0	47.0	19.0
1 ¼ "	50	140.0	57.0	21.0
2 "	63	164.0	70.0	21.0
2 ½ "	75	184.0	83.0	21.0
3 "	90	202.5	97.5	22.0
4 "	110	228.0	118.0	22.5
5 "	125	266.0	133.0	23.0
5 ¼ "	140	263.0	145.0	24.5
6 "	160	298.5	167.0	25.5
7 "	180	329.0	188.0	27.0
8 "	200	375.0	207.5	30.0
9 "	225	398.0	233.0	32.5
10 "	250	427.0	257.0	30.5
11 "	280	451.0	287.0	32.0
12 "	315	489.0	325.0	29.0

AS PER IS : 8008 - 1976 (PART VII)  
MAX. WORKING PRESSURE 10kg / cm<sup>2</sup>