

PRECUT SHIMS

While installing rotating equipment, Shims play a crucial role in **accurately positioning** the equipment during **shaft alignment**.

Lack of shim of proper size and thickness leads to **improper alignment**. This in turn causes vibration and ultimately leads to unplanned breakdowns and enormous downtime expenses.



- **Flat, burr-free** shims make the job of alignment accurate and reliable.
- Easy to **fit and remove**.
- Made up of corrosion resistant **Stainless Steel (SS 304)**, allowing re-use.
- **Round edged** to avoid cuts.
- Clearly marked thickness on each shim for **quick identification**.
- Quick and safe insertion and removal of shim using **Tab Hole**.
- Saves a lot of time, labor and money **wasted by hand cut shims**.
- **Accurate alignment** improves equipment performance and hence it's reliability.

Dimensional Data: (All dimensions are in mm)

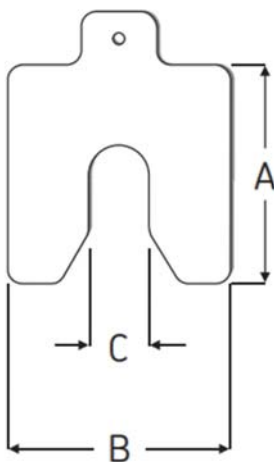

Type	Size A X B	Slot Size C	Suitable for Motor Foot Bolt Size	Standard Thicknesses
NST 1	40 X 40	13	M10, 3/8"	0.05, 0.1, 0.2, 0.4, 0.5, 0.7, 1.0, 2.0, 3.0
NST 2	50 X 50	17	M12, 1/2"	
NST 3	75 X 75	21	M16, M20, 5/8", 3/4"	
NST 4	100 X 100	27	M24, M27, 1"	
NST 5	125 X 125	45	M30 – M42, 1-1/8" – 1-3/4"	
NST 6	150 X 150	55	M48, M52, 2"	

(Other sizes and thicknesses can be offered as per customer specifications.)