

COPPER TUBE TERMINALS HEAVY DUTY LONG BARREL

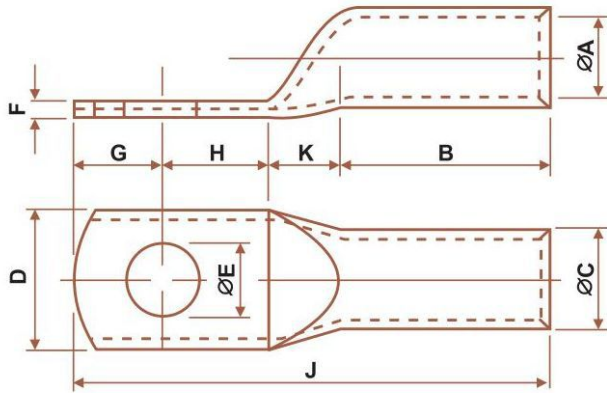

MATERIAL :

COPPER TUBE TO BS 1977/ISI191 (PART V)

E. C. GRADE 99.25% IACS

FINISH :

ELECTRO TINNED TO BS 1872 (1984)

MM ²	ØE BOLT	ØA	ØC	D	F	B	K	H	G	J	CAT NO
25	M8	7.0	9.0	13	2.0	16	5	12	8	41	KK-282
35	M8	8.0	10.6	15	2.6	20	5	14	9	48	KK-283
50	M8	9.2	12.2	17	3.0	26	7	16	10	59	KK-284
70	M10	11.5	15.0	20	3.5	28	7	19	12	66	KK-285
95	M12	12.8	17.0	24	4.2	32	10	20	12	74	KK-286
120	M12	14.8	19.6	28	4.8	35	10	23	14	82	KK-287
150	M12	16.0	21.2	30	5.2	38	10	24	14	86	KK-288
185	M12	18.0	24.0	34	6.0	43	12	23	17	95	KK-289
240	M16	22.0	28.0	40	6.0	50	12	30	20	112	KK-290
300	M20	23.5	30.0	43	6.5	55	12	31	22	120	KK-291
400	M20	26.8	34.8	50	8.0	58	12	40	25	135	KK-292