

Jamato®

CZ SERIES

Economy Type Overlock / Safety Stitch Machine

Jamato CZ, designed and manufactured under cutting-edge technology, supports your good quality garment manufacturing for today and future.



Sub Models

CZ6000 1 needle 3 thread overlock machine for blind hemming operation



- Features:
With exclusive sewing parts and blind hemming guide, it dedicates soft & beautiful stitches to you.
- Application:
- T-shirt, Polo-shirt etc.
 - Light to medium weight material



CZ6003 1 needle 3 thread overlock machine for general seaming



- Features:
Applicable to the single needle overlock procedure on all kinds of knitted and woven garments.
- Application:
- All kinds of knitted and woven material
 - Light to medium weight material



CZ6016-61 1 needle 3 thread overlock machine for rolled hemming



- Features:
You can easily change the overlock width among 2mm, 3mm, 4mm by changing the stitch plate tongue and presserfoot tongue (the conversion between 2mm and 3mm only need to change the stitch plate tongue) without sacrificing finished quality.
- Application:
- Knitted, woven, napkin, scarves, handkerchief, etc.
 - Extra light to light weight material



CZ6016 1 needle 3 thread overlock machine for rolled hemming



- Features:
Rubber-coated feed dogs prevent your material from damaging. So, it is especially suitable for fine material such as silk stocking, pantyhose.
- Application:
- Silk stocking, knitted, pajamas etc.
 - Extra light to lightweight material



CZ6020/6025 CZ6120/6125



2 needle 4 thread overlock machine for general seam attaching reinforcing tape

- Features:
The change of overlock width from 4mm to 8mm can be adjusted by any of the two models. Also, it can be widely used in any type of knitted outer/inner wear. (CZ6120/6125)
- Remarks:
The presser foot of CZ6020/6120 has a wide pressing surface.
The presser foot of CZ6025/6125 has a narrow passage for tape on pressing surface.
- Application:
- All kinds of knitted and woven material
 - CZ6020/6025: light to medium weight material
 - CZ6120/6125: light to heavy weight material



CZ6500 2 needle 5 thread safety stitch machine



- Features:
For general safety stitch operation.
- Application:
- All kinds of knitted and woven material
 - Light to medium weight material



CZ610 2 needle 5 thread safety stitch machine



- Features:
Equipped with high lift looper drive mechanism, coarse mesh feed dog, tractor type presser foot for smooth feeding performance even at thick material of heavy weight material.
- Application:
- Denim, corduroy etc.
 - Medium to heavyweight material



CZ6520/6525 3 needle 6 thread multi-purpose safety stitch machine



- Features:
It can make various seam styles as illustrated without changing any parts.
- Remark:
The presserfoot of CZ6520 has a wide pressing surface.
The presserfoot of CZ6525 has a narrow passage for tape on pressing surface.
- Application:
- All kinds of knitted and woven material
 - Light to medium weight material

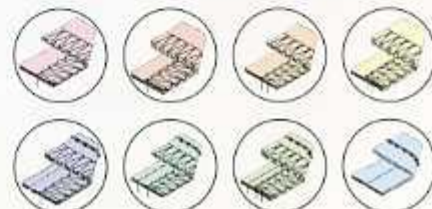

ENJOY THE WORLD LEADING TECHNOLOGY

Prevent oil leakage

Oil stain is one of the biggest headaches for all manufacturers. Using Yamato CZ series, no oil stain, no worry any more!

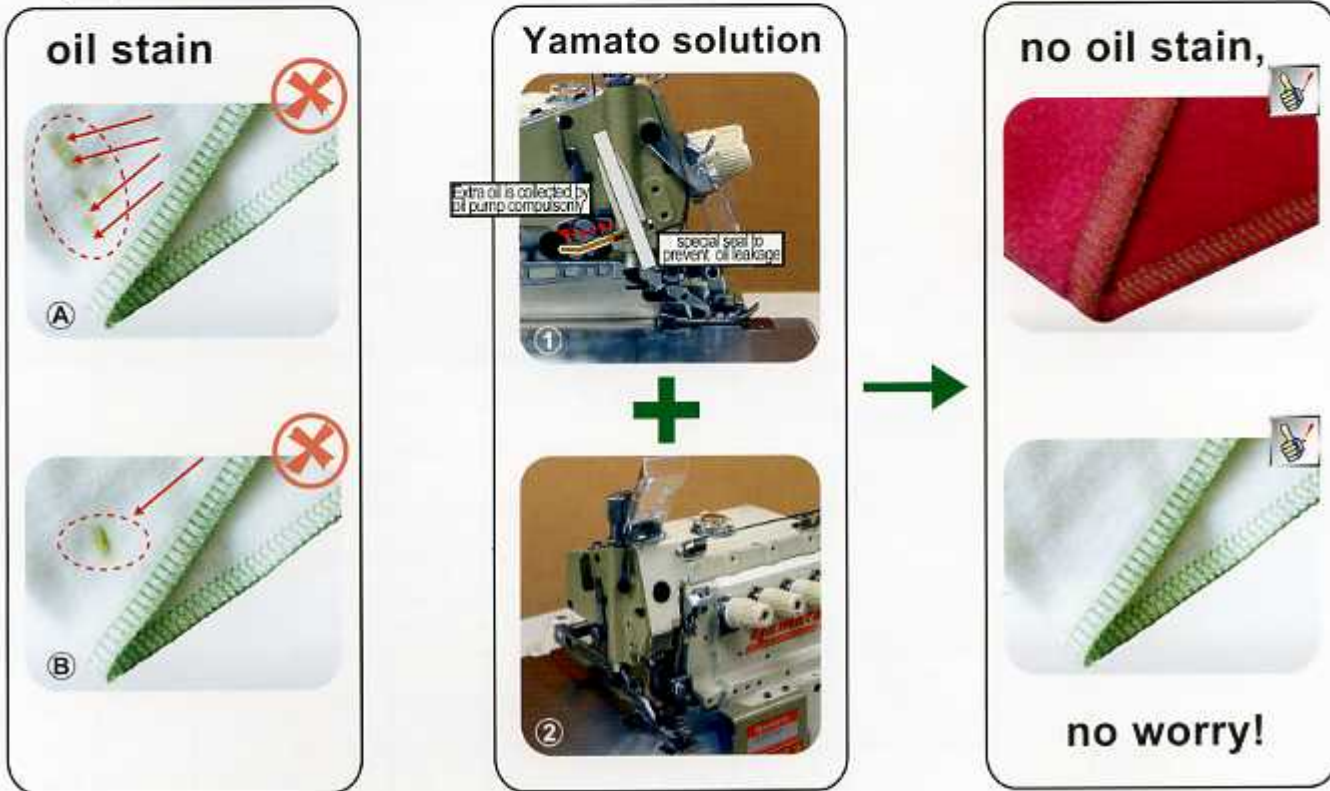

Pic ① pump collecting extra oil mechanism (patent pending)

CZ Series adopts the same needle bar mechanism and special seal, which are used in AZ Series, Japanese made high-end overlock machine. Thus, the risk of oil leakage around needle bar area is minimized. (no need to worry about the finish shown in Pic. (A))

Pic ② sealed needle bar mechanism

The mixture of lint and dust causes not only needle bar abrasion, but also oil stain (Pic. (B)). Yamato's sealed needle bar mechanism solves above problems, enhancing thoroughly the quality of your finished garment!

Low noise/little vibration, durable machine!

Precise reasonable design, high quality parts ensure CZ series for quick acceleration, low noise and little vibration. Thus, the fatigue of operators is minimized. And instable operation and injuries are considerably decreased. Moreover, low noise/little vibration proves less abrasion of the machine, which means longer running life.



No oil stain, no worry

... AT AN ECONOMICAL PRICE!

Jamato®

Multi-purpose machine

Epoch-making CZ6120/6125, enables any operator to easily change the seam width from 5mm to 6mm by changing only stitch plate and presser foot tongue. Meanwhile, it ensures uniform quality!

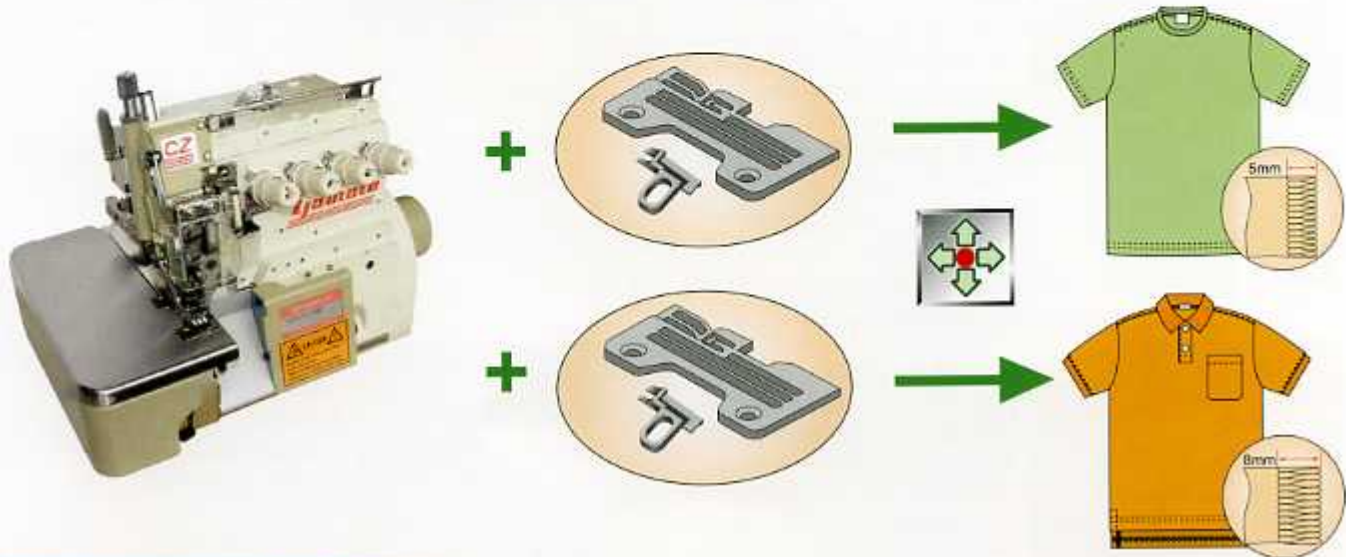

Perfect seaming & stitching



Adjustment of stitch length and differential ratio is very simple & easy.

Adjustment of stitch length is done by a push button system.
Adjustment of differential ratio is done by lever.
Respond quickly to the change of material and order.

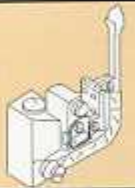

HR Device

HR device effectively prevents the temperature of needle tip from getting too high. Thus the problems of needle breakage, skipping stitch, needle hole are successfully prevented, especially when synthetic thread and/or synthetic fabric used.



Achieving perfect seaming & stitching.

You can get tight seam without excessive thread tension.

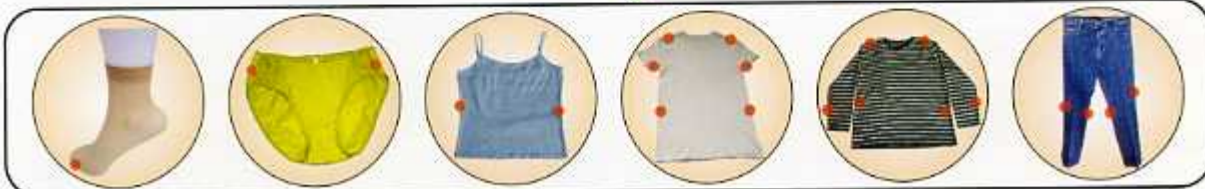

Optional Devices

B3 manual back tack device



Suitable for: CZ6003
Function:
Usually, the bar tacking process is needed after single needle overlock on the sleeves of under wear, etc. But with this device, the thread chain will be sewn into the fabric at the beginning of sewing. Thus, bar tacking process is saved.

UB6 air-operated uncurling device



Suitable for: CZ6003, CZ6120/
CZ6020/6025
Function:
It flattens the both inside and curls when sewing. Thus, you need to stop machine and flatten curled edge so often. Besides, cutting margin becomes more while minimizing the waste, effectively enhancing productivity & quality of finished garments and saving cost.

K1/C automatic thread chain cutter/venturi device (horizontal type)



Suitable for: CZ6500, CZ610
Function:
Controlled by compressed air, it sucks the thread chain and cuts them, and collects the dust. This package saves your time, and gives you a clean working environment!

BT43 semi-automatic back tacker



Suitable for: CZ6120/6125,
CZ6020/6025
Function:
2 needle overlock on the sleeve T-shirts, polo shirt can be accomplished in one step. And, the length of chain to be sewn into the seam becomes 20mm shorter than conventional model, so that it is applicable for short distance of as well.

MT22 automatic tape & thread cutter



Suitable for: CZ6003,
CZ6120/6125,
CZ6020/6025
Function:
You can cut the tape and thread chain quickly and neatly at your desired point in sewing process for enhancement of the productivity.

K2/C automatic thread chain cutter (vertical type) venturi device



Suitable for: CZ6120/6125,
CZ6020/6025
Function:
Controlled by compressed air, the thread chain and cuts them and collects the dust. This package saves your time, and gives you a clean working environment!

CH20: seam sensing blind hemming device



Suitable for: CZ6000
Function:
The sensor detects cross seam sensitively and the guide automatically slides moderately to adjust the seam. Thus, it can successfully prevent burst.

Numbering of Model

CZ6125-Y6DF



- ① Symbol of series
- ② Class No. : 60 = Overlock, 65 = Safety Stitch
- ③ Sub model
- ④ Needle distance: 0=Single Needle, X = 2mm, Y = 2.4mm, A = 3.2mm, C
- ⑤ Overedge seam width: 4 = 4mm, 5 = 5mm, 6 = 6mm, 7=7mm, 8 = 8mm
- ⑥ Feeding mode: D = Differential feed
- ⑦ Type of upper knife: F = Fl

Submodels / Specifications

Model	Code	Image	Symbol	Class	Sub Model	Needle Distance	Overedge Seam Width	Feeding Mode	Upper Knife	Stitch Length	Stitch Width
CZ6000	504		DCX27	1	3	-	4	1-4			6 65
CZ6003	504		DCX27	1	3	-	4	1-4			6 65
CZ6016-61	504		DCX27	1	3	-	3	0.6-2			5 67
CZ6016	504		DCX27	1	3	-	2	0.6-2			4 65
CZ6020	514		DCX27	2	4	2, 2.4	4, 5,6	1-4			6 65
CZ6025	514		DCX27	2	4	2, 2.4	4, 5,6	1-4		1:0.7 - 1:2.3	6 65
CZ6120	514		DCX27	2	4	2.4	5,6, 7,8	1-4			6 60
CZ6125	514		DCX27	2	4	2.4	5,6, 7,8	1-4			6 60
CZ6500	504,401		DCX27	2	5	3.2, 5	4, 5	1-4			6 65
CZ6520	514,401		DCX27	3	6	3.2+2.4	5,6	1-4 (2-5)			6 65
CZ6525	514,401		DCX27	3	6	3.2+2.4	5,6	1-4 (2-5)			5.5 65
CZ610	504,401		DMX13	2	5	5	6	2-5		1:0.6 - 1:3	6 57



YAMATO SEWING MACHINE (NINGBO) CO., LTD.

No. 641 WEST HENGSHAN ROAD, BEILUN, NINGBO, ZHEJIANG PROVINCE, CHINA
 P.C.: 315800
 Tel: +86-574-86800518, 86800558 Fax: +86-574-86800555
 E-mail: yamato@yamato-china.net

Specification and appearance on this catalog are subject to change without notice.
 For correct handling of products described on this catalog, please read instructions carefully before operation.

YAMATO SEWING MACHINE MFG. CO., LTD. 4-12, 4-CHOME, NISHI-TENMAI, KITAHUJI, OSAKA 590-0047 JAPAN TEL: +81-6-6394-9821 FAX: +81-6-6394-7199 E-mail: export-dept@yamato-sewing.com	YAMATO U.S.A. INC. (Head Office) 3485 LAKEMONT BLVD, FORT MILL, SC 29710 U.S.A. Tel: +1-803-545-0334 Fax: +1-803-548-0469	YAMATO EXICO OFFICE C/O CASA DIAZ DE MADRINAS DE COBER, S.A. DE C.V. PRAY BARRANCO TERESA DE MER NO. 20, COLONIA OBISPERA MEXICO D.F. C.P. 06600 Tel: +52-55-5764-9050 Fax: +52-55-5575-1470	YAMATO (HONG KONG) CO., LTD. RM. 1417, TUNG YING BLDG., 150 NATHAN ROAD KOWLOON, HONG KONG Tel: +852-2721-0251 Fax: +852-2723-0444 E-mail: yamato@yamato-sewing.com.hk
YAMATO SINGAPORE PTE. LTD. 6 HARPER ROAD #03-01, LEONG HUAT BLDG., SINGAPORE 369674 Tel: +65-6287-1955 Fax: 65-6287-1028 E-mail: sales@yamato-sewing.com.sg	YAMATO SINGAPORE PTE. LTD. India liaison office NO.7, VALAYANADU MPAN ROAD, K.P. LAYOUPPARIK.G. COMPLEX, KUMAR NAGAR, TRIPUNJAVUR 602 002 INDIA Sales-HP: +91-98433-60210, Service-HP: +91-98432-58956 Tel: +91-423-395-107 E-mail: yamatoindia@rediffmail.com	YAMATO EUROPE GmbH. HAMBURG-FREEPORT ATRIKASTRASSE 4 D-20457 HAMBURG GERMANY Telefon: 2152157 FAX: 2152157 Tel: +49-40-355347-0 Fax: +49-40-354371 E-mail: sales@yamato.de	YAMATO SEWING MACHINE MFG. CO., LTD. QINGDAO OFFICE SUNSHINE TOWER 2007, 91, XIANG GANG ROAD QINGDAO, CHINA, ZIP 266071 Tel: +86-532-5702175 Fax: +86-532-6762172